

Crimp Terminal

1. Part No.: 991900TC301,991900TC001
2. Part Name: 9919 Terminal
3. Material: Phosphor or Brass bronze
4. Finishing: Tin plated
5. Applicable PC board thickness: 1.6mm

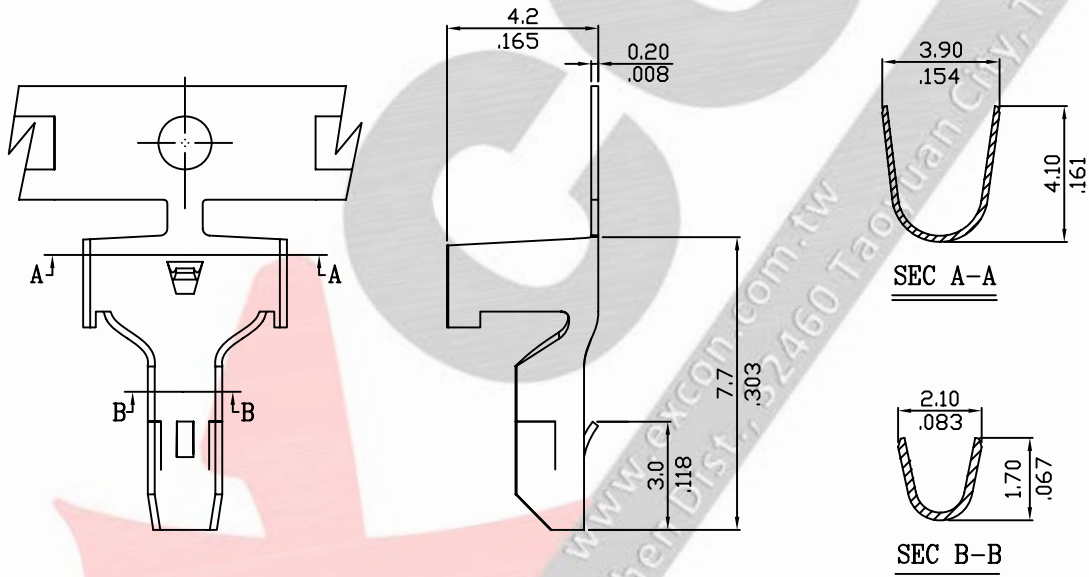
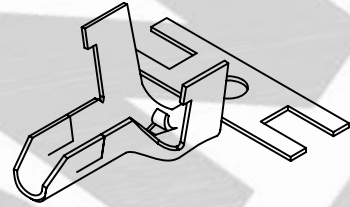

Ordering Information and Dimensions:

Part No.	Wire Range	Insulation O.D.	Material	Finishing	Q'ty/reel
991900TC301	AWG#18~#22	2.10mm	Phosphor	Tin plated	7,000pcs
991900TC001	AWG#18~#22	2.10mm	Brass	Tin plated	7,000pcs

Part Code Information:

9919-WW XX YY

① ② ③ ④

① Series Name

② Circuits Number

00 For Terminal

③ Product Type

TC=Terminal

④ Material/Finishing/Color

001=Brass bronze,tin plated

301=phosphor,tin plated