

### ■ Specifications

1. Current rating: 3A AC/DC
2. Voltage rating: 250V AC/DC
3. Withstand voltage: 800V AC/minute
4. Insulation resistance: 1000M  $\Omega$  min
5. Contact resistance: 20m  $\Omega$  max
6. Temperature range: -25°C to +105°C
7. Applicable PC board thickness: 1.6mm(.063")
8. Circuits: 3~15 circuits available

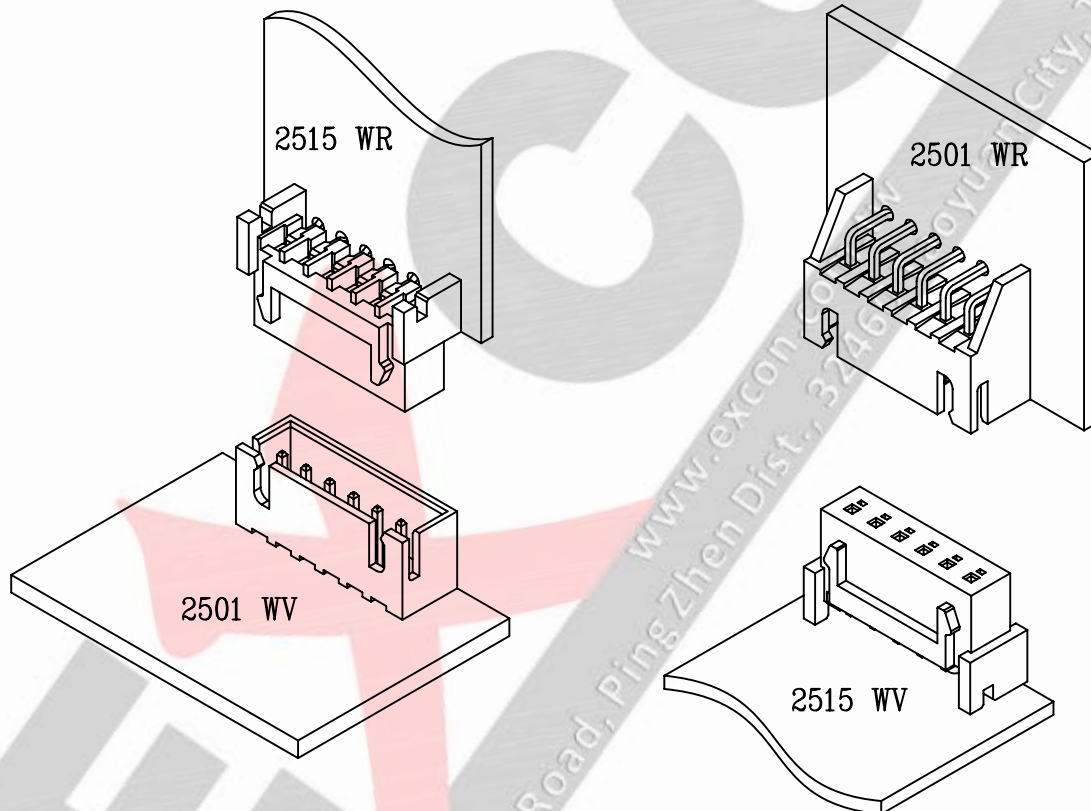

### Part Code Information:

2515-WW XX YYY

① ② ③ ④

① Series Name

② Circuits Number

03~15

00 For Terminal

③ Product Type

WV=Wafer (Vertical type)

WR=Wafer (Right angle type)

④ Material/Finishing/Color

001=NY 66 94V-0,Natural Color

### Wafer (Vertical type)

1. Part No.: 2515xxWV001
2. Part Name: 2515 Wafer
3. Material: Nylon 66 UL 94V0  
Pin: Phosphor bronze, Tin plated
4. Color: Natural

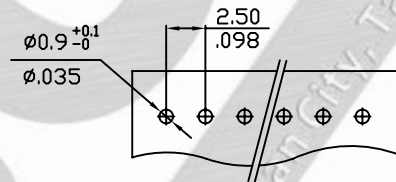
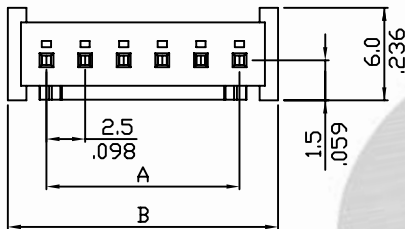
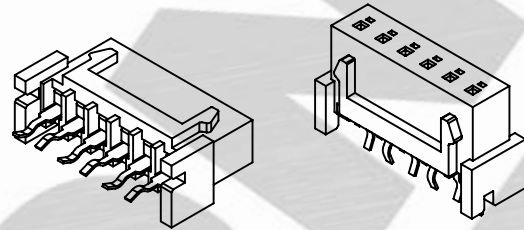

**RECOMMENDED PCB LAYOUT**

(PCB T=1.0~1.6mm)  
(PCB T=.039~.063in)

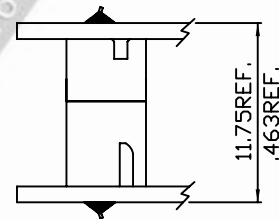
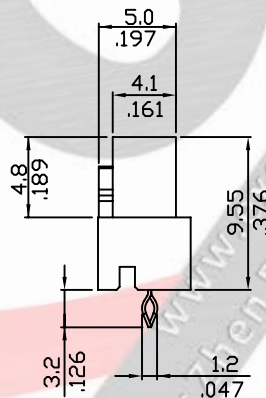
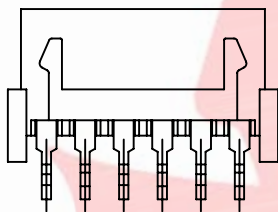

**Mating Dimensions**

### Ordering Information and Dimensions:

Part No.	Circuits	Dim A	Dim B	Part No.	Circuits	Dim A	Dim B
251503WV001	3	5.0(.197)	10.0(.394)	251510WV001	10	22.5(.886)	27.5(1.083)
251504WV001	4	7.5(.295)	12.5(.492)	251511WV001	11	25.0(.984)	30.0(1.181)
251505WV001	5	10.0(.394)	15.0(.591)	251512WV001	12	27.5(1.083)	32.5(1.280)
251506WV001	6	12.5(.492)	17.5(.689)	251513WV001	13	30.0(1.181)	35.0(1.378)
251507WV001	7	15.0(.591)	20.0(.787)	251514WV001	14	32.5(1.280)	37.5(1.476)
251508WV001	8	17.5(.689)	22.5(.886)	251515WV001	15	35.0(1.378)	40.0(1.575)
251509WV001	9	20.0(.787)	25.0(.984)				

### Part Code Information:

2515-WW XX YY

① ② ③ ④

① Series Name

② Circuits Number  
03~15

③ Product Type  
WV=Wafer (Vertical type)

④ Material/Finishing/Color  
001=NY 66 94V-0,Natural Color

### Wafer (Right angle type)

1. Part No.: 2515xxWR001
2. Part Name: 2515 Wafer
3. Material: Nylon 66 UL 94V0  
Pin: Phosphor bronze, Tin plated
4. Color: Natural

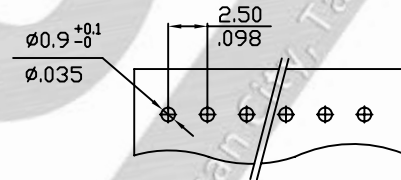
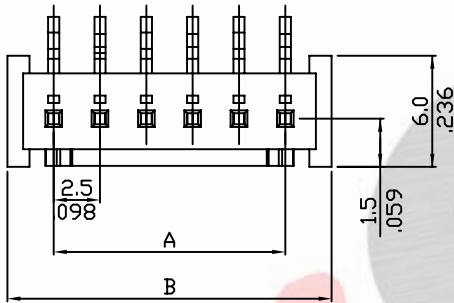
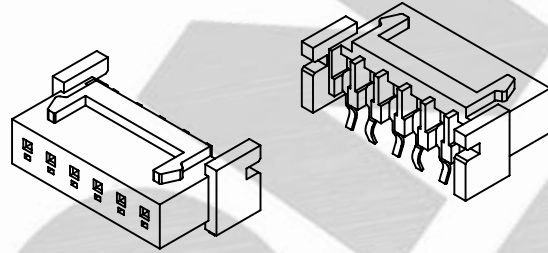

#### RECOMMENDED PCB LAYOUT

(PCB T=1.0~1.6mm)  
(PCB T=.039~.063in)

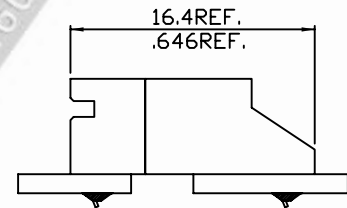
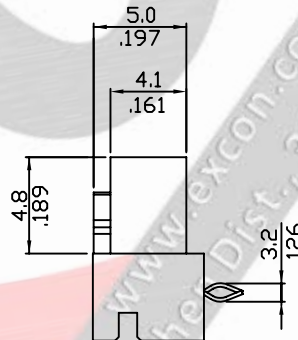
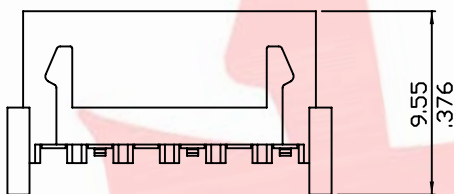

#### Mating Dimensions

### Ordering Information and Dimensions:

Part No.	Circuits	Dim A	Dim B	Part No.	Circuits	Dim A	Dim B
251503WR001	3	5.0(.197)	10.0(.394)	251510WR001	10	22.5(.886)	27.5(1.083)
251504WR001	4	7.5(.295)	12.5(.492)	251511WR001	11	25.0(.984)	30.0(1.181)
251505WR001	5	10.0(.394)	15.0(.591)	251512WR001	12	27.5(1.083)	32.5(1.280)
251506WR001	6	12.5(.492)	17.5(.689)	251513WR001	13	30.0(1.181)	35.0(1.378)
251507WR001	7	15.0(.591)	20.0(.787)	251514WR001	14	32.5(1.280)	37.5(1.476)
251508WR001	8	17.5(.689)	22.5(.886)	251515WR001	15	35.0(1.378)	40.0(1.575)
251509WR001	9	20.0(.787)	25.0(.984)				

### Part Code Information:

2515-WW XX YY

① ② ③ ④

① Series Name

② Circuits Number  
03~15

③ Product Type  
WR=Wafer (Right angle type)

④ Material/Finishing/Color  
001=NY 66 94V-0,Natural Color